

K2: K-Series Line of Locks



Introduction	$\frac{K^2}{1}$				
Cam Locks	$\frac{K^2}{2}$ $\frac{K^2}{3}$ $\frac{K^2}{4}$ $\frac{K^2}{5}$				
Drawer/Door Locks	$\frac{K^2}{6}$				
Gang Locks	$\frac{K^2}{7}$				
Glass Door Lock	$\frac{K^2}{8}$				
Gear Lock	$\frac{K^2}{9}$				
Snap Bolt Lock	$\frac{K^2}{10}$				
Glass Door Lock	$\frac{K^2}{11}$				
Plunger Locks	$\frac{K^2}{12}$ $\frac{K^2}{13}$ $\frac{K^2}{14}$				
Ratchet Locks	$\frac{K^2}{15}$				
Keys	$\frac{K^2}{16}$				



8 LOCKS IN ONE

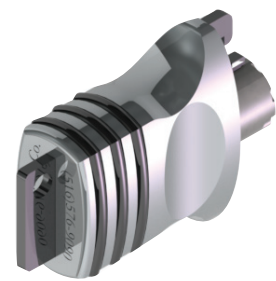

**KEY FUNCTIONS
AS A PULL**

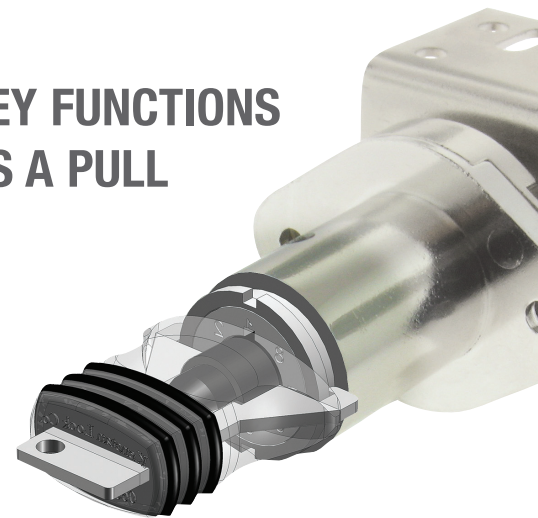

INSERTABLE CORE

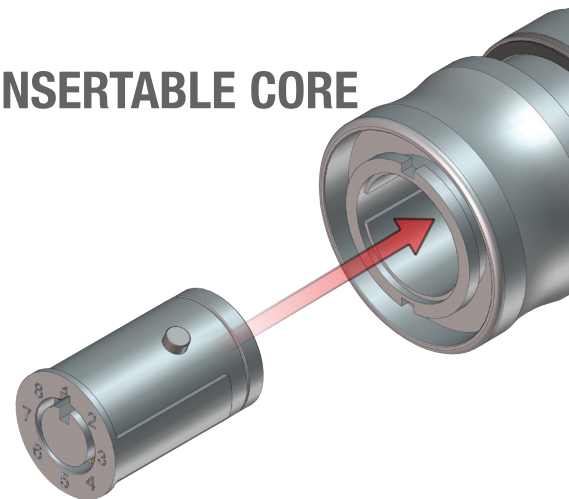

K2: K-Series Line of Locks

Standard K2 Plating Finishes



* Special K2 Plating Finishes



* Custom K2 Plating Finish

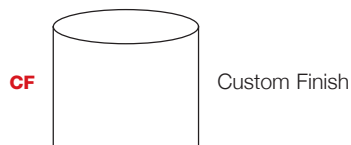

* Extended lead-time and plating lot charges may apply to Special and Custom finishes. Please call Kenstan for details.

The lock face and the corresponding tubular key have been designed by adding an interlocking feature. This interlocking feature creates a solid connection between the key and the lock. Hence, the inserted key can be used as a Pull without damaging the key or the lock.

The lock can now be ordered without the core which can be inserted later, much like our Interchangeable Core and Removable Core Locks. This will allow case builders to install the housings (without the keyed cores) into their cases, stock them and ship them to the stores. Once the cases arrive at the store, loss prevention can install the separately ordered cores and maintain complete Key Control. Of course, if the End-User and/or the Case Builder prefer to receive the complete keyed lock we can ship it as such.

Delivery

At Kenstan, we assemble every lock to order and strive to meet your requested in-house date. Our standard lead time is to ship within two weeks from the receipt of your order. Rush orders and emergency services are available.

Plating

The **K2** line standard plating finish is Polished Nickel.

A wide range of special plating finishes is also available, including Satin Nickel, Polished Brass, Matte Black, Statuary Bronze, Satin Brass and Custom Finishes to match your showcase hardware.

Please note: Extended lead-time and plating lot charges may apply to Special and Custom finishes. Please call Kenstan for details.

Key Control

Keymatic locks and keys are built to a high level of precision, making key duplication very difficult. Please note: We recommend our factory original key for smooth lock operation. Use of non-Kenstan copy will void the Kenstan warranty on our locks.

We can register your keys and maintain your key plans by store, retail department, showcase/cabinets, or office and we maintain a historical database of key numbers.

The stamped number on the **K2** key will have a prefix letter "P" followed by five numerical digits of which the last one represents the lock setting (1 to 8).

The **Red Change Tool** is stamped with the same code as the operating key, except the setting code is 0.

Key Retaining vs. Non-Key Retaining Lock Function

The **K2** line standard operation is a Key Retaining function (captive), which means that the operating key can be removed in the locked position only; therefore, the lock cannot be accidentally left in the open/unlocked position.

K2 locks can also be supplied as Non-Key Retaining (non-captive), which allows the key to be removed in both the locked and unlocked positions, this feature will eliminate the key pull feature on some locks.

Item Number

To determine your item number enter the **RED** option code for each section as in the example below.

A	B	C	D	E	F	G	H	I
CL	K2	05	1203	PN	Y	Y	W	106

A Lock Style

CL Cam Lock

B Core Type

K2 K² Keymatic Pull

C Housing Length**MAXIMUM MATERIAL THICKNESS**

	WOOD	METAL	GLASS	BARREL LENGTH
03	1/2"	5/8"	1/2"	15/16"
04	3/4"	13/16"	11/16"	1-1/8"
05	1-1/8"	1-3/16"	1"	1-1/2"

D Cam Rotation

	LOCKED	OPEN
0312	3	12
0306	3	6
0603	6	3
0609	6	9
0912	9	12
0906	9	6
1203	12	3
1209	12	9

E Plating Finish

Extended lead-time and plating lot charges **may** apply to Special and Custom finishes.

Special Finish	PN	Polished Nickel
	SN	Satin Nickel
	PB	Polished Brass
	SB	Satin Brass
	BL	Matte Black
	ST	Statuary Bronze
	CF	Custom Finish

F Key Retaining

* Note: This option will eliminate the KEYPULL feature.

Y	Yes
N*	No

G Insert Core

Y	Yes
N	Pack Core Separately
ND	Ship Core to Different Location

H Material Installation

W	Wood
WF	Wood Flush Mount
M	Metal
GR	Glass with Round Hole
GD	Glass with Double "D" Hole
O	Other - No Mounting Hardware

Note: Keys are not included with this lock. See page 16 to order keys.

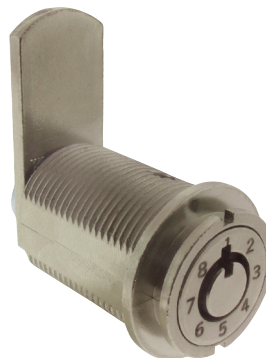

ATTENTION: A 7/8" hole is required to mount this lock.

Note: All Cam Locks come with a 1-1/4" Straight Cam unless a different cam is chosen.

I Cam Type**STRAIGHT**

101	5/8"
102	3/4"
103	7/8"
104	1"
105	1-1/8"
106	1-1/4"
107	1-3/8"
108	1-1/2"
110	1-3/4"
112	2"
116	2-1/2"

1/8" OFFSET

303	7/8"
306	1-1/4"
308	1-1/2"
312	2"

1/4" OFFSET

403	7/8"
404	1"
406	1-1/4"
408	1-1/2"
410	1-3/4"
412	2"
414	2-1/4"

3/8" OFFSET

504	1"
506	1-1/4"
508	1-1/2"
512	2"

1/2" OFFSET

606	1-1/4"
608	1-1/2"
610	1-3/4"
612	2"

5/8" OFFSET

712	2"
------------	----

HOOK

202	3/4"
204	1"
206	1-1/4"
208	1-1/2"
210	1-3/4"

PIN CAM

P604	9/16" offset
-------------	--------------

These offset Cams are not reversible.

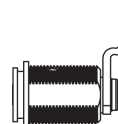

Continued

Data Sheet

C HOUSING LENGTHS 03

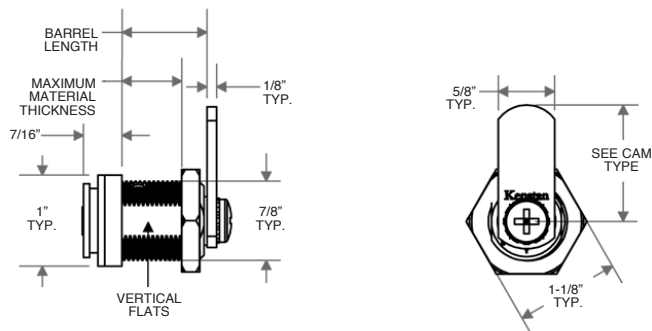

A 7/8" hole is required to mount this lock.

C HOUSING LENGTHS 04 and 05

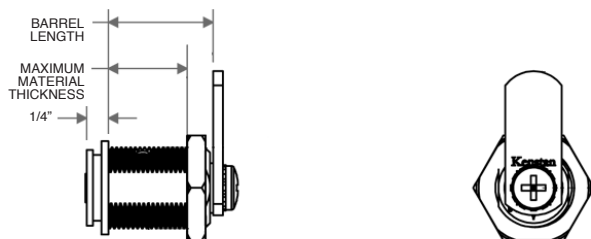

A 7/8" hole is required to mount this lock.

D CAM ROTATION EXAMPLE

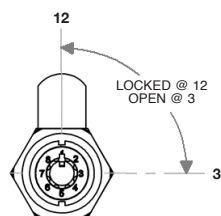

H WOOD INSTALLATION W

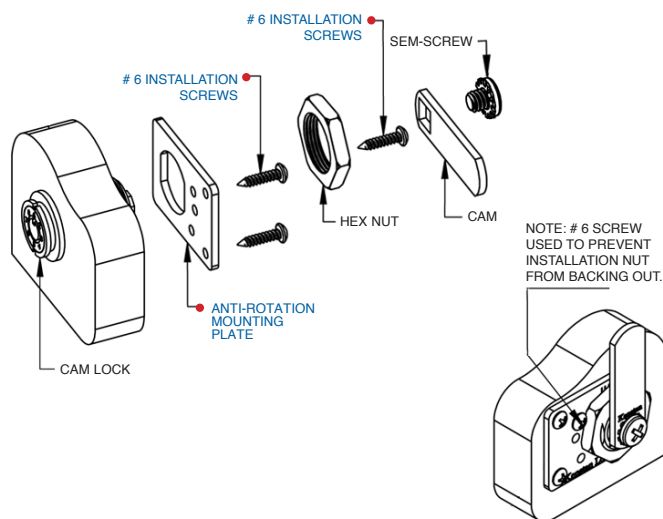

H WOOD INSTALLATION FLUSH MOUNT WF

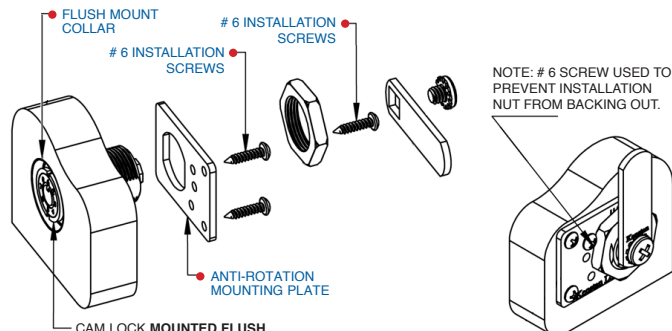

H METAL INSTALLATION M

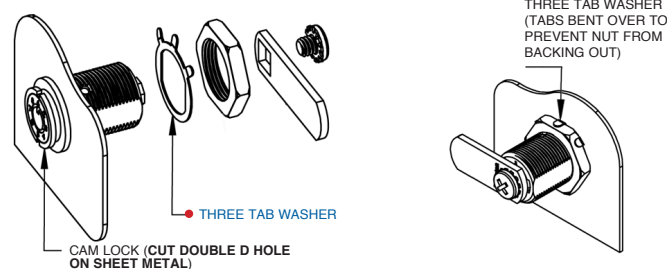

H GLASS INSTALLATION - ROUND HOLE GR

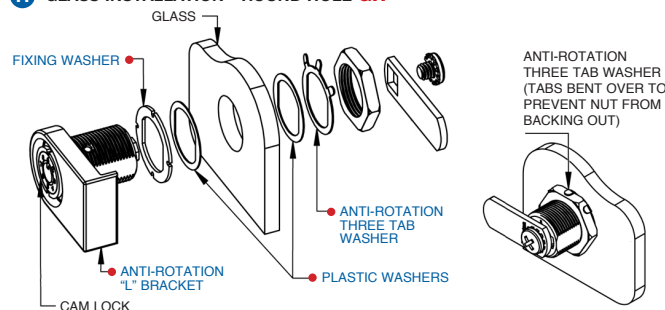

H GLASS INSTALLATION - DOUBLE D HOLE GD

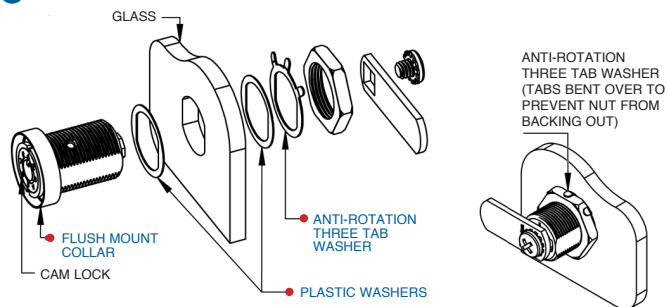

I CAM TYPES

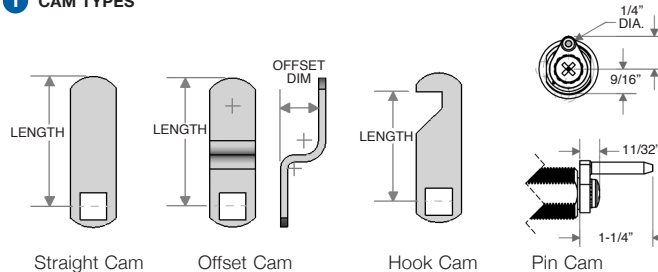

Note: All Offset cams are not reversible.

Item Number

To determine your item number enter the **RED** option code for each section as in the example below.

A	B	C	D	E	F	G	H
CL	K3	05	1203	PN	Y	W	106

A Lock Style

CL Cam Lock

B Core Type

K3 K³ Keymatic Pull

C Housing Length**MAXIMUM MATERIAL THICKNESS**

	WOOD	METAL	GLASS	BARREL LENGTH
02	-	7/16"	5/16"	11/16"
03	1/2"	5/8"	1/2"	15/16"
04*	3/4"	13/16"	11/16"	1-1/8"
05	1-1/8"	1-3/16"	1"	1-1/2"
10	1-5/8"	-	-	1-13/16"
11	1-13/16"	-	-	2"
12	2-1/8"	-	-	2-3/8"
13	2-1/2"	-	-	2-13/16"
14	2-11/16"	-	-	3"
15	3"	-	-	3-3/8"

D Cam Rotation

	LOCKED	OPEN
0312	3	12
0306	3	6
0309*	3	9
0603	6	3
0612*	6	12
0609	6	9
0912	9	12
0903*	9	3
0906	9	6
1203	12	3
1206*	12	6
1209	12	9

E Plating Finish

Extended lead-time and plating lot charges may apply to Special and Custom finishes.

Special Finish	PN	Polished Nickel
	SN	Satin Nickel
	PB	Polished Brass
	SB	Satin Brass
	BL	Matte Black
	ST	Statuary Bronze
	CF	Custom Finish

F Key Retaining

* Note: This option will eliminate the KEYPULL feature.

Y	Yes
N*	No

G Material Installation

W	Wood
WF	Wood Flush Mount
M	Metal
GR	Glass with Round Hole
GD	Glass with Double "D" Hole
O	Other - No Mounting Hardware

Note: Keys are not included with this lock.

See page 16 to order keys.

*Cam rotations are 170 degrees on key retaining locks. All 170 or 180 degree cam locks are clockwise, unless specified.

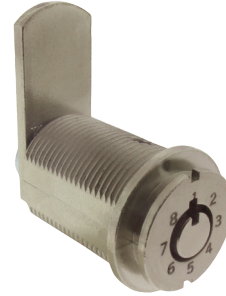

Note: All Cam Locks come with a 1-1/4" Straight Cam unless a different cam is chosen.

H Cam Type**STRAIGHT**

101	5/8"
102	3/4"
103	7/8"
104	1"
105	1-1/8"
106	1-1/4"
107	1-3/8"
108	1-1/2"
110	1-3/4"
112	2"
116	2-1/2"

1/8" OFFSET

303	7/8"
306	1-1/4"
308	1-1/2"
312	2"

1/4" OFFSET

403	7/8"
404	1"
406	1-1/4"
408	1-1/2"
410	1-3/4"
412	2"
414	2-1/4"

3/8" OFFSET

504	1"
506	1-1/4"
508	1-1/2"
512	2"

1/2" OFFSET

606	1-1/4"
608	1-1/2"
610	1-3/4"
612	2"

5/8" OFFSET

712	2"
------------	----

HOOK

202	3/4"
204	1"
206	1-1/4"
208	1-1/2"
210	1-3/4"

PIN CAM

P604	9/16" offset
-------------	--------------

FOR SWITCH KIT

SL	No Cam*
-----------	---------

*Switch option available. See Page A10 to order switch kit.

Continued

Data Sheet

C HOUSING LENGTHS 02, 03, 04 and 05

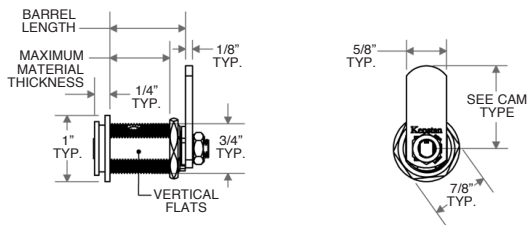

C HOUSING LENGTHS 10, 11, 12, 13, 14 and 15

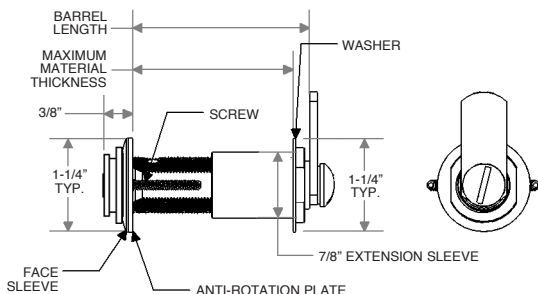

CAM LOCK - EXPLODED VIEW

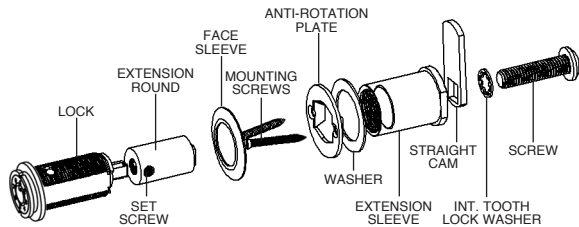

D CAM ROTATION EXAMPLE

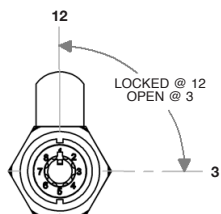

All 180 degree rotations are clockwise, unless specified.

G WOOD INSTALLATION W

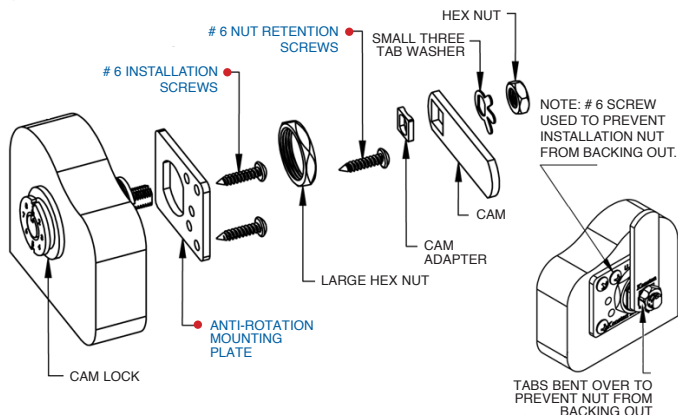

G WOOD INSTALLATION FLUSH MOUNT WF

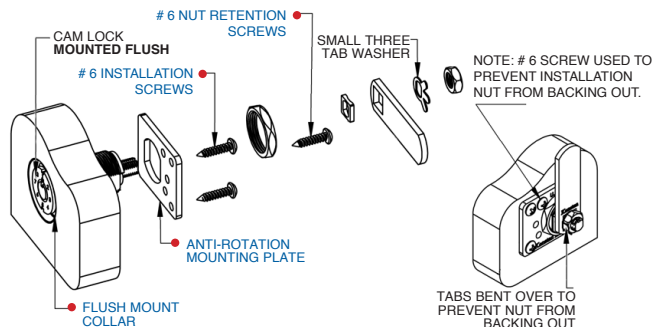

G METAL INSTALLATION M

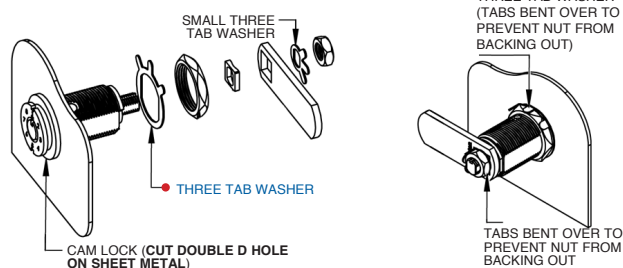

G GLASS INSTALLATION - ROUND HOLE GR

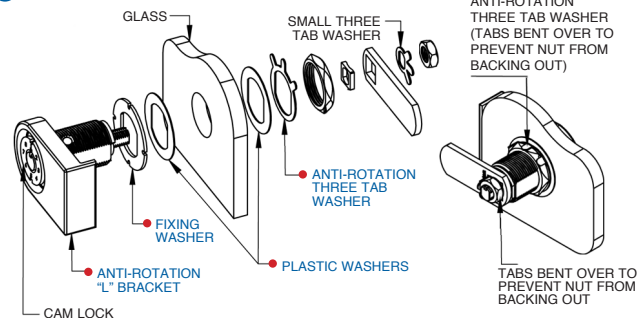

G GLASS INSTALLATION - DOUBLE D HOLE GD

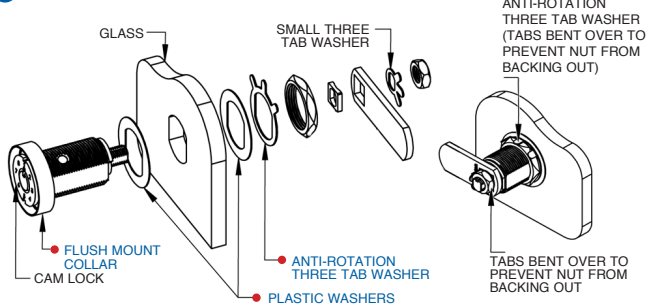

H CAM TYPES

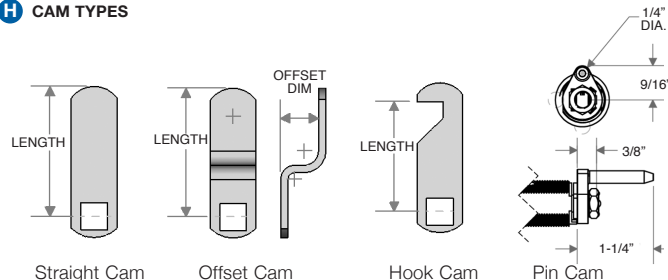

Note: All Offset cams are reversible.

Item Number

To determine your item number enter the **RED** option code for each section as in the example below.

A	B	C	D	E	F	G
DL	K2	S	2001	PN	Y	Y

A Lock Style

DL Drawer/Door Lock

B Core Type

K2 K² Keymatic Pull

C Housing Length

S 13/16"
M 1-1/16"
L 1-3/16"

D Bolt Type**STRAIGHT BOLT**

2001 1-1/16"
2002 1-11/16"
2003 2-5/16"
2004 3-1/8"

3/8" OFFSET BOLT

2205 1-5/8"

DIECAST SPRING BOLT

3209 1-5/16" Std.

INVERTED SLIDING SPRING BOLT

3410 1-5/16" Left
3411 1-5/16" Right

E Plating Finish

Extended lead-time and plating lot charges may apply to Special and Custom finishes.

Special Finish	PN	Polished Nickel
	SN	Satin Nickel
	PB	Polished Brass
	SB	Satin Brass
	BL	Matte Black
	ST	Statuary Bronze
	CF	Custom Finish

F Key Retaining

* Note: This option will eliminate the KEYPULL feature on Straight and 3/8" Offset Bolt models.

N* No
Y Yes

G Insert Core

Y Yes
N Pack Core Separately
ND Ship Core to Different Location

Note: Keys are not included with this lock.
See page 16 to order keys.



"Throw" (distance bolt travels from the locked to unlocked position) is 5/16".

All dimensions shown are in the locked position.

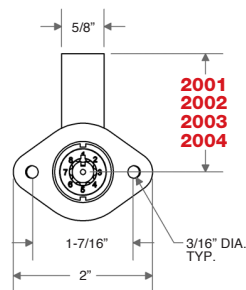
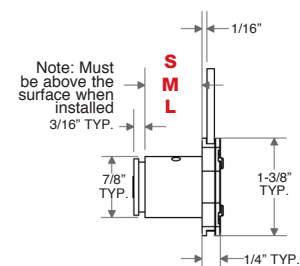
D STRAIGHT BOLT**C HOUSING LENGTH**

Note: Must be above the surface when installed 3/16" TYP.

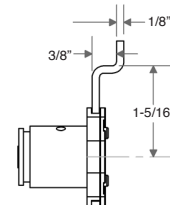
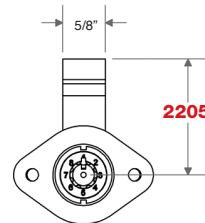
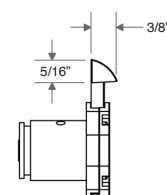
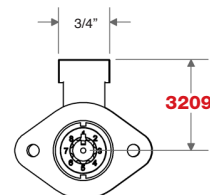
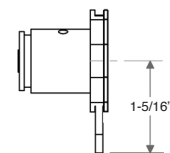
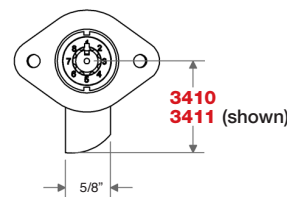
D 3/8" OFFSET BOLT**D DIECAST SPRING BOLT (3/16" bolt engagement recommended)****D INVERTED SLIDING SPRING BOLT**

Data Sheet

Gang Lock

GL

Item Number

To determine your item number enter the **RED** option code for each section as in the example below.

A	B	C	D	E	F	G
GL	K2	S	2448	PN	Y	Y

A Lock Style

GL Gang Lock

B Core Type

K2 K² Keymatic Pull

C Housing Length

S 13/16"
M 1-1/16"
L 1-3/16"

D Mount Style/Bar Length

Notch for Pin must be on Bottom of Drawer	FRONT MOUNT LOCKED UP	
	2424	24"
	2436	36"
	2448	48"
	24CL	Custom
Notch for Pin must be on Top of Drawer	SIDE MOUNT LOCKED UP	
	2624	24"
	2636	36"
	2648	48"
	26CL	Custom
Notch for Pin must be on Bottom of Drawer	FRONT MOUNT LOCKED DOWN	
	2824	24"
	2836	36"
	2848	48"
	28CL	Custom
Notch for Pin must be on Top of Drawer	SIDE MOUNT LOCKED DOWN	
	3024	24"
	3036	36"
	3048	48"
	30CL	Custom

E Plating Finish

Extended lead-time and plating lot charges **may** apply to Special and Custom finishes.

Special Finish	PN	Polished Nickel
	SN	Satin Nickel
	PB	Polished Brass
	SB	Satin Brass
	BL	Matte Black
	ST	Statuary Bronze
Special Finish	CF	Custom Finish

F Key Retaining

N No
Y Yes

G Insert Core

Y Yes
N Pack Core Separately
ND Ship Core to Different Location

Note: Keys are not included with this lock. See page 16 to order keys.

Throw (distance bolt travels from the locked to unlocked position) is 5/16".

FRONT MOUNT - FRONT VIEW

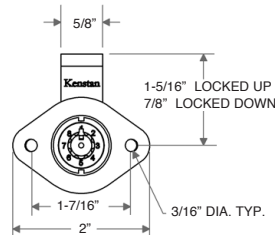

FRONT MOUNT - SIDE VIEW

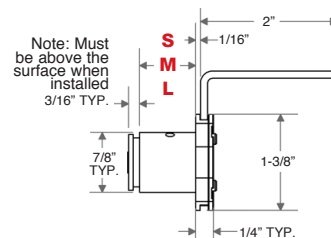

FRONT MOUNT (Shown with a Gang 3C Kit)

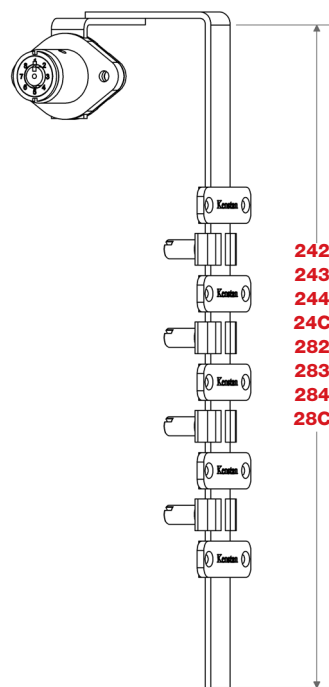

SIDE MOUNT (Shown with a Gang 3C Kit)

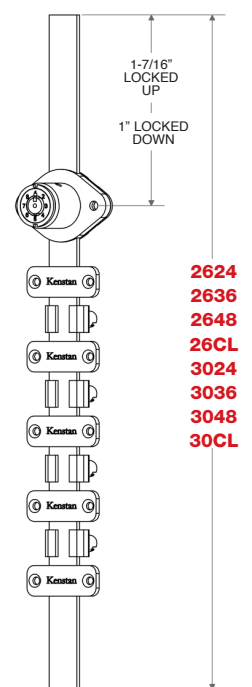

Gang Lock Packages

To determine your item number enter the **RED** option code for each section as in the example below.

A	B	C
GANG	3	C

GANG 3C A kit with three adjustable stops, three 1-1/8" pins, three lock washers, and four closed bar guides.

A Package

GANG

B Number of Drawers

2
3
4

C Pin Length

A 5/8"
B 3/4"
C 1-1/8"
D 1-7/8"

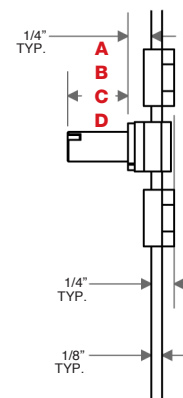

Item Number

To determine your item number enter the **RED** option code for each section as in the example below.

A	B	C	D	E	F	G	H	I
DL	K2	29	V	01	PN	Y	Y	C

A Lock Style

DL Door Lock

B Core Type

K2 K² Keymatic Pull

C Housing Style

29 Glass Mount Housing

D Bolt Type

V Vertical
I Inverted

E Bolt Length

01 1-1/8"
CL Custom

F Plating Finish

Extended lead-time and plating lot charges
may apply to Special and Custom finishes.

Special Finish	PN	Polished Nickel
	SN	Satin Nickel
	PB	Polished Brass
	SB	Satin Brass
	BL	Matte Black
	ST	Statuary Bronze
	CF	Custom Finish

G Key Retaining

N No
Y Yes

H Insert Core

Y Yes
N Pack Core Separately
ND Ship Core to Different Location

I Glass Thickness**ADHESIVE BACK - SINGLE DOOR ONLY**

A 1/4" (6mm)
B 1/4" - 13/32" (6mm-10mm)

RUBBER BACK - SINGLE AND DOUBLE DOORS

C 1/4" (6mm)
D 1/4" - 13/32" (6mm-10mm)

Note: Keys are not included with this lock.
See page 16 to order keys.



"Throw" (distance bolt travels from the locked to unlocked position) is 3/8".

All dimensions shown are in the locked position.

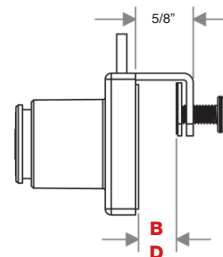
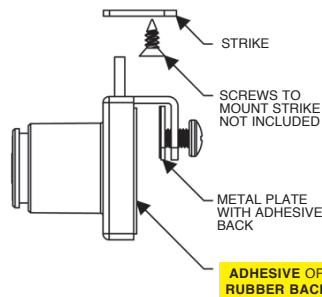
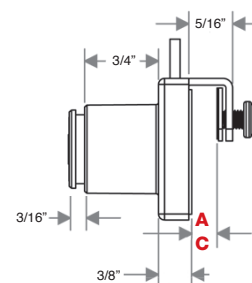
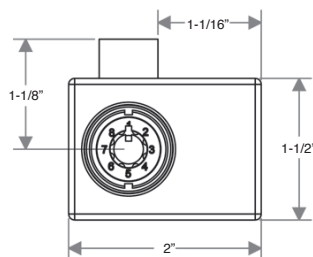
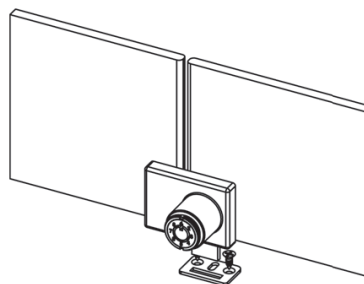
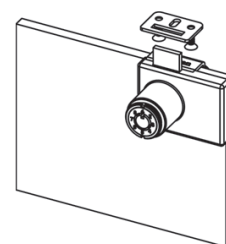
DEAD BOLT (VERTICAL SHOWN)**DOUBLE DOOR APPLICATION (INVERTED SHOWN)****SINGLE DOOR APPLICATION**

Data Sheet

Item Number

To determine your item number enter the **RED** option code for each section as in the example below.

A	B	C	D	E	F	G
DL	K2	37D	N	PN	Y	Y

A Lock Style

DL Door Lock

B Core Type

K2 K² Keymatic Pull

C Housing Style/Bolt

37D Dual Gear Lock (Std.)
37S Single Gear Lock

D Bar Length

N No Bar (Standard)
C Custom

E Plating Finish

Extended lead-time and plating lot charges may apply to Special and Custom finishes.

Special Finish	PN	Polished Nickel
	SN	Satin Nickel
	PB	Polished Brass
	SB	Satin Brass
	BL	Matte Black
	ST	Statuary Bronze
	CF	Custom Finish

F Key Retaining

N No
Y Yes

G Insert Core

Y Yes
N Pack Core Separately
ND Ship Core to Different Location

Material Installation

W Wood
M Metal

Note: Keys are not included with this lock. See page 16 to order keys.



"Throw" (distance bolt travels from the locked to unlocked position) is 1.16" per side
All dimensions shown are in the locked position.

GEAR LOCK

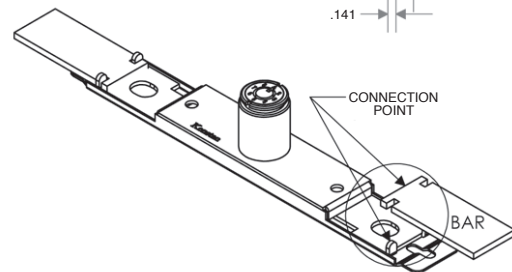
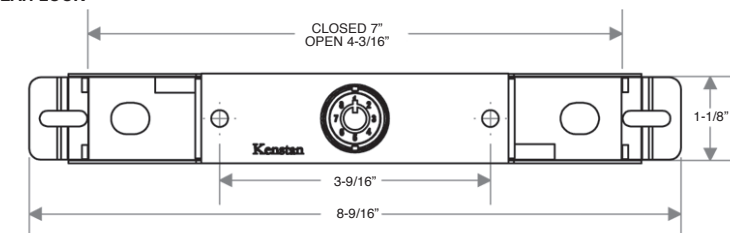

EXPLODED VIEW WOOD INSTALLATION

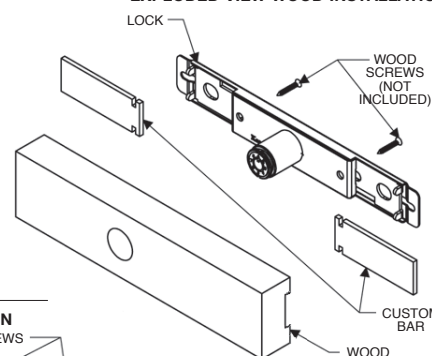

EXPLODED VIEW METAL INSTALLATION

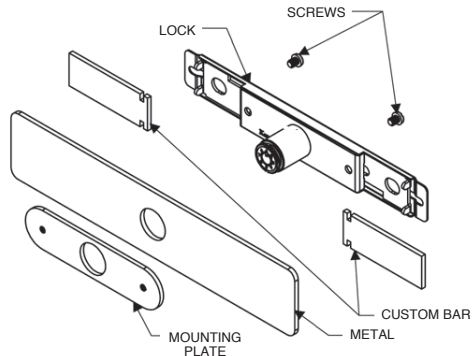

Item Number

To determine your item number enter the **RED** option code for each section as in the example below.

A	B	C	D	E	F	G	H
DL	K2	S	36	PN	N	Y	B

A Lock Style

DL Drawer/Door Lock

B Core Type

K2 K² Keymatic Pull

C Housing Length/Style

STANDARD

S 13/16"

M 1-1/16"

L 1-3/16"

LOW PROFILE

SL 13/16"

ML 1-1/16"

LL 1-3/16"

D Bolt Type

SNAP BOLT

36 3/4"

E Plating Finish

Extended lead-time and plating lot charges may apply to Special and Custom finishes.

Special Finish	PN	Polished Nickel
	SN	Satin Nickel
	PB	Polished Brass
	SB	Satin Brass
	BL	Matte Black
	ST	Statuary Bronze
	CF	Custom Finish

F Key Retaining

N No

G Insert Core

Y Yes
N Pack Core Separately
ND Ship Core to Different Location

H Strike Profile

A Low
B Standard
C Large

Note: Keys are not included with this lock. See page 16 to order keys.

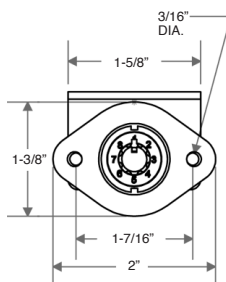
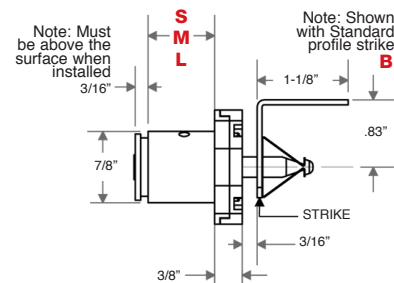
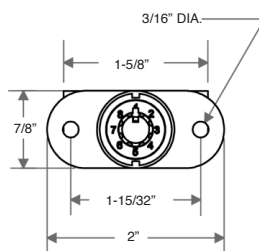
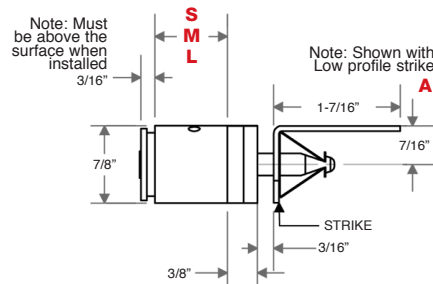
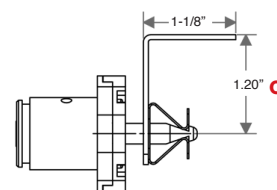
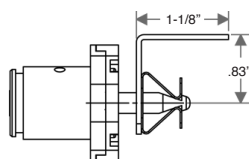
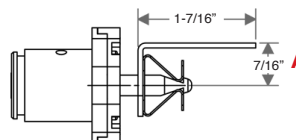

All dimensions shown are in the locked position.

D STANDARD SNAP BOLT**C HOUSING LENGTH****D LOW PROFILE SNAP BOLT****C HOUSING LENGTH****H STRIKE PROFILE (SHOWN WITH STANDARD HOUSING)**

Data Sheet

Item Number

To determine your item number enter the **RED** option code for each section as in the example below.

A	B	C	D	E	F	G	H
DL	K2	39	06	02	PN	Y	Y

A Lock Style

DL Door Lock

B Core Type

K2 K² Keymatic Pull

C Housing Style

39 Glass Mount Housing

D Locked Position

06 6
12 12
03 3
09 9

E Bolt Length

01 15/16"
02 1-13/32" (Standard)

F Plating Finish

Extended lead-time and plating lot charges **may** apply to Special and Custom finishes.

Special Finish	PN	Polished Nickel
	SN	Satin Nickel
	PB	Polished Brass
	SB	Satin Brass
	BL	Matte Black
	ST	Statuary Bronze
	CF	Custom Finish

G Key Retaining

N No
Y Yes

H Insert Core

Y Yes
N Pack Core Separately
ND Ship Core to Different Location

Note: Keys are not included with this lock. See page 16 to order keys.



"Throw" (distance bolt travels from the locked to unlocked position) is 0.29

All dimensions shown are in the locked position.

GLASS DOOR LOCK (For 1/4" glass application)

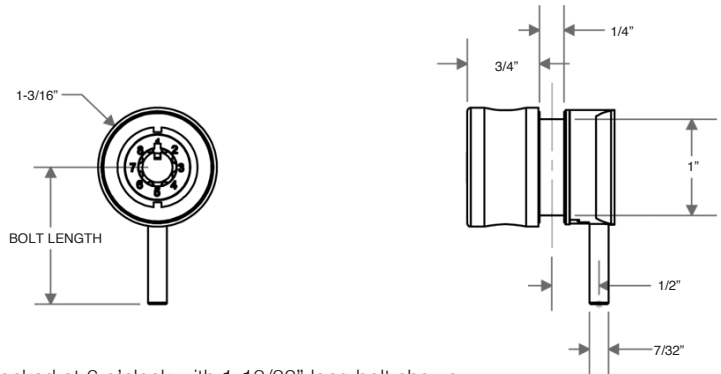

Locked at 6 o'clock with 1-13/32" long bolt shown.

EXPLODED VIEW

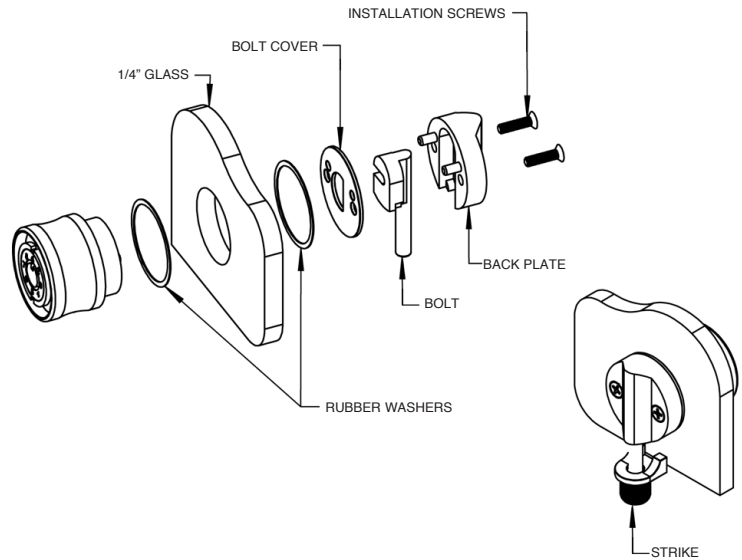

Item Number

To determine your item number enter the **RED** option code for each section as in the example below.

A	B	C	D	E	F	G
PL	K2	40	S3	PN	Y	Y

A Lock Style

PL Plunger Lock

B Core Type

K2 K² Keymatic Pull

C Housing Style

40 Oval Flange

D Plunger Type/Length**S SERIES**

S1 3/8"
S2 7/16"
S3 5/8"

New **T SERIES**

T1 1/4"
T3 9/16"

ROUND SERIES

R1 3/8"
R2 7/16"
R3 5/8"

ROUND EXTENDED SERIES

R4 1-3/16"
R5 1-5/16"
R6 1-11/16"
R7 2-7/16"

E Plating Finish

Extended lead-time and plating lot charges may apply to Special and Custom finishes.

Special Finish	PN	Polished Nickel
	SN	Satin Nickel
	PB	Polished Brass
	SB	Satin Brass
	BL	Matte Black
	ST	Statuary Bronze
	CF	Custom Finish

F Key Retaining

N No
Y Yes

G Insert Core

Y Yes
N Pack Core Separately
ND Ship Core to Different Location

Note: Keys are not included with this lock. See page 16 to order keys.

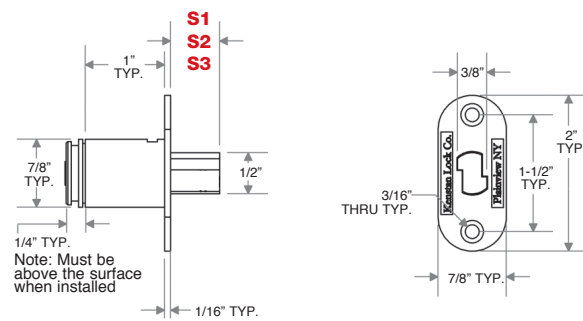
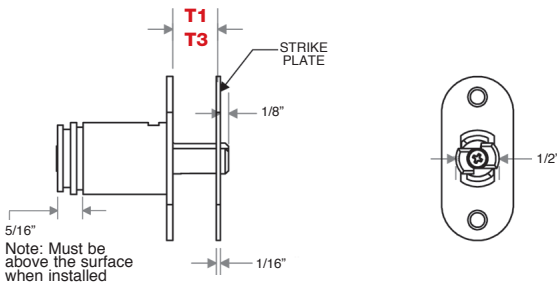
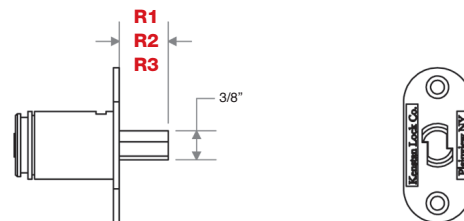
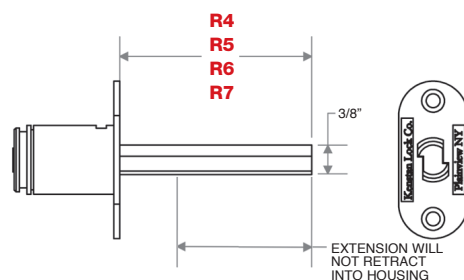

All dimensions shown are in the locked position.

D S SERIES**D T SERIES****D ROUND SERIES****D ROUND EXTENDED SERIES (Plunger travels 9/16")**

Data Sheet

Item Number

To determine your item number enter the **RED** option code for each section as in the example below.

A	B	C	D	E	F	G
PL	K2	45	S3	PN	Y	Y

A Lock Style

PL Plunger Lock

B Core Type

K2 K² Keymatic Pull

C Housing Style

45 No Flange

D Plunger Type/Length

S SERIES

S1 3/8"
S2 7/16"
S3 5/8"

New

T SERIES

T1 1/4"
T3 9/16"

ROUND SERIES

R1 3/8"
R2 7/16"
R3 5/8"

ROUND EXTENDED SERIES

R4 1-3/16"
R5 1-5/16"
R6 1-11/16"
R7 2-7/16"

E Plating Finish

Extended lead-time and plating lot charges may apply to Special and Custom finishes.

Special Finish	PN	Polished Nickel
	SN	Satin Nickel
	PB	Polished Brass
	SB	Satin Brass
	BL	Matte Black
	ST	Statuary Bronze
	CF	Custom Finish

F Key Retaining

N No
Y Yes

G Insert Core

Y Yes
N Pack Core Separately
ND Ship Core to Different Location

Note: Keys are not included with this lock. See page 16 to order keys.



All dimensions shown are in the locked position.

D S SERIES

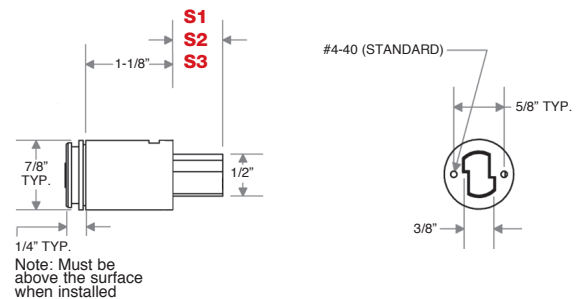

D T SERIES

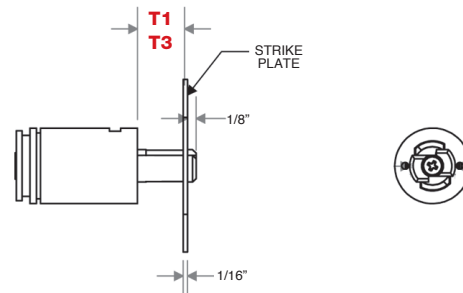

D ROUND SERIES

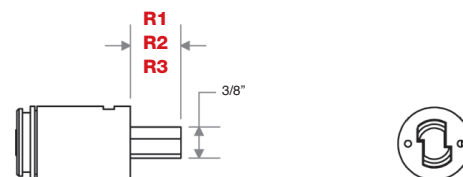

D ROUND EXTENDED SERIES (Plunger travels 9/16")

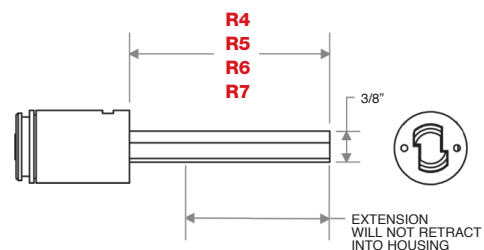

Item Number

To determine your item number enter the **RED** option code for each section as in the example below.

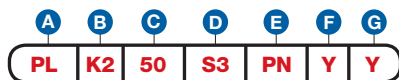
**A Lock Style**

PL Plunger Lock

B Core Type

K2 K² Keymatic Pull

C Housing Style

50 Round Flange

D Plunger Type/Length**S SERIES**

S1 3/8"
S2 7/16"
S3 5/8"

New **T SERIES**

T1 1/4"
T3 9/16"

New **L SERIES**

L3 3/8"

ROUND SERIES

R1 3/8"
R2 7/16"
R3 5/8"

ROUND EXTENDED SERIES

R4 1-3/16"
R5 1-5/16"
R6 1-11/16"
R7 2-7/16"

E Plating Finish

Extended lead-time and plating lot charges may apply to Special and Custom finishes.

PN Polished Nickel
SN Satin Nickel
PB Polished Brass
SB Satin Brass
BL Matte Black
ST Statuary Bronze
CF Custom Finish

F Key Retaining

N No
Y Yes

G Insert Core

Y Yes
N Pack Core Separately
ND Ship Core to Different Location

Note: Keys are not included with this lock. See page 16 to order keys.

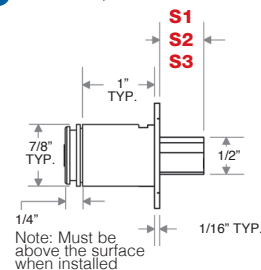

All dimensions shown are in the locked position.
NOTE: A 1.19" hole is required to mount this glass lock.

D S SERIES (Parts included same as Round Series)

Note: Must be above the surface when installed

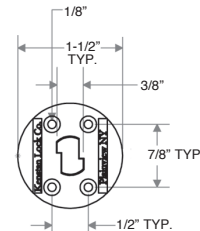
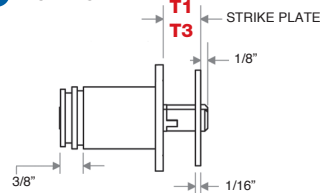
**D T SERIES**

Note: Must be above the surface when installed

PARTS INCLUDED	QTY.
(a) DOUGHNUT	2
(b) J BRACKET (anti-rotation)	1
(c) PLASTIC WASHER	4
(d) PLASTIC SPACER	2
(e) SCREW	8
(f) STRIKE PLATE	1

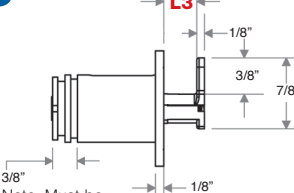
D L SERIES

Note: Must be above the surface when installed

PARTS INCLUDED	QTY.
(a) DOUGHNUT	1
(b) J BRACKET (anti-rotation)	1
(c) PLASTIC WASHER	2
(d) PLASTIC SPACER	1
(e) SCREW	4

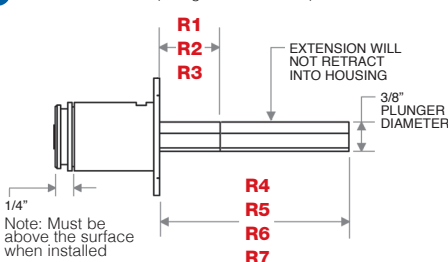
D ROUND SERIES (Plunger travels 9/16")

Note: Must be above the surface when installed

PARTS INCLUDED	QTY.
(a) DOUGHNUT	1
(c) PLASTIC WASHER	2
(d) PLASTIC SPACER	1
(e) SCREW	4

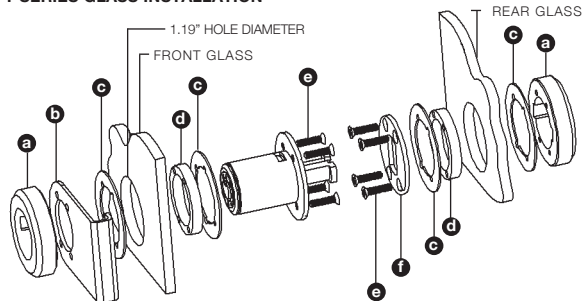
T SERIES GLASS INSTALLATION

(a) DOUGHNUT
(b) J BRACKET (anti-rotation)
(c) PLASTIC WASHER
(d) PLASTIC SPACER
(e) SCREW
(f) STRIKE PLATE

Data Sheet

Item Number

To determine your item number enter the **RED** option code for each section as in the example below.

A	B	C	D	E	F	G
RL	K2	60	B9	PN	Y	Y

A Lock Style

RL Ratchet Lock

B Core Type

K2 K² Keymatic Pull

C Housing Style

60 Ratchet

D Bar Type

B1 Standard
B2 Adjustable
B5 Stick on (Outer Surface)
B9 Stick on (Inner Surface)

Best Seller

E Plating Finish

Extended lead-time and plating lot charges may apply to Special and Custom finishes.

PN Polished Nickel
SC Satin chrome
CF Custom Finish

F Key Retaining

N No
Y Yes (Dead Bolt Design)

G Insert Core

Y Yes
N Pack Core Separately
ND Ship Core to Different Location

Note: Keys are not included with this lock.
 See page 16 to order keys.

D STANDARD BAR **B1**

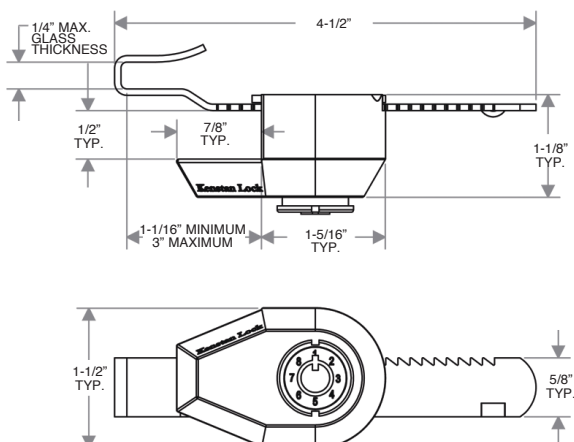

D ADJUSTABLE BAR **B2**

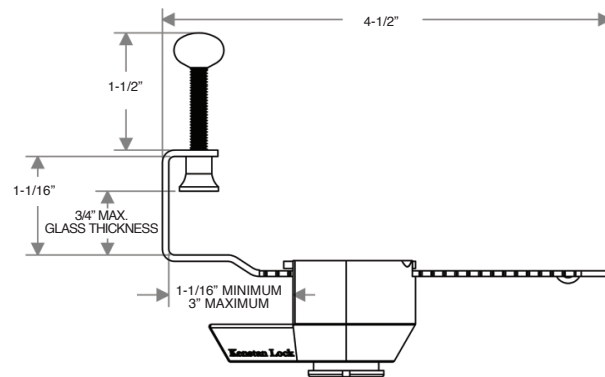

D STICK ON BAR (Outer Surface) **B5**

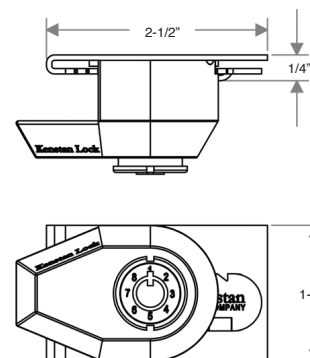

D STICK ON BAR (Inner Surface) **B9**

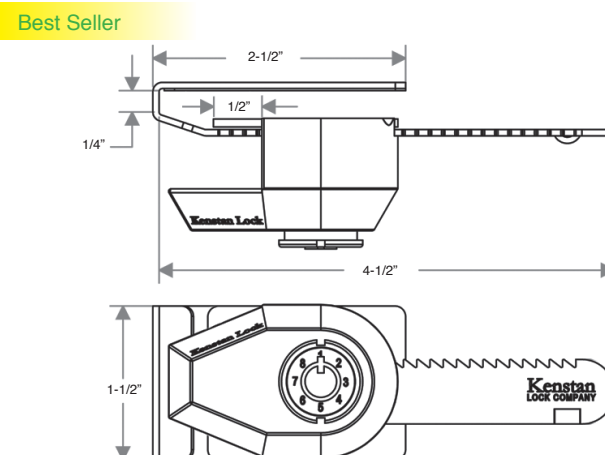

K4: K-Series Line of Locks



Introduction	$\frac{K^4}{1}$				
Cam Lock	$\frac{K^4}{2}$ $\frac{K^4}{3}$				
Drawer/Door Locks	$\frac{K^4}{4}$ $\frac{K^4}{5}$				
Gang Locks	$\frac{K^4}{6}$				
Plunger Locks	$\frac{K^4}{7}$ $\frac{K^4}{8}$				
Ratchet Lock	$\frac{K^4}{9}$				
Keys	$\frac{K^4}{10}$				

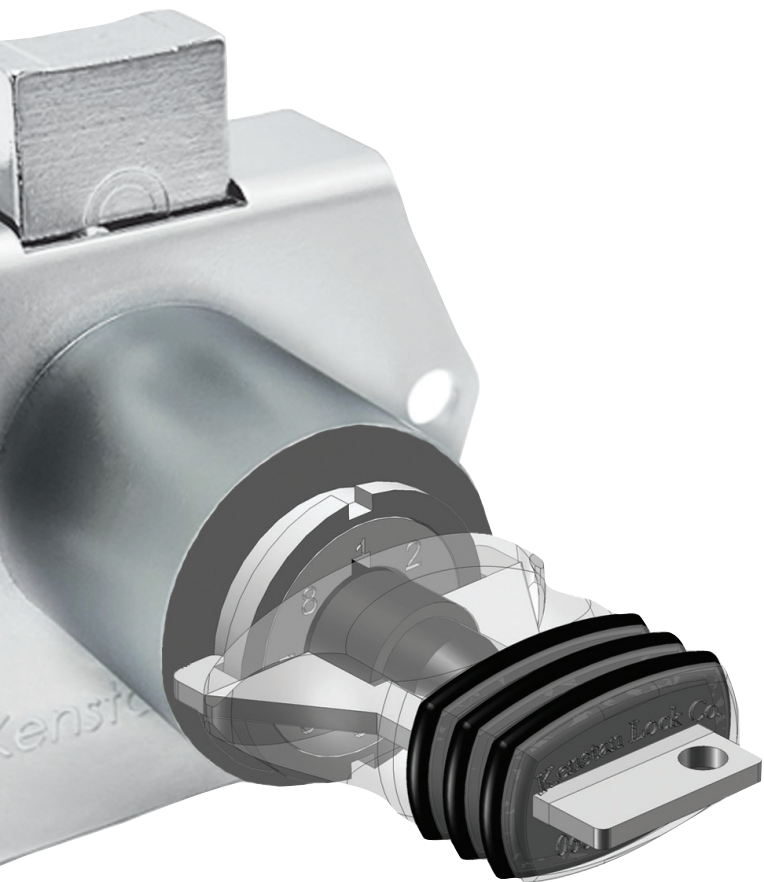

8 LOCKS IN ONE



**KEY FUNCTIONS
AS A PULL**



INSERTABLE CORE

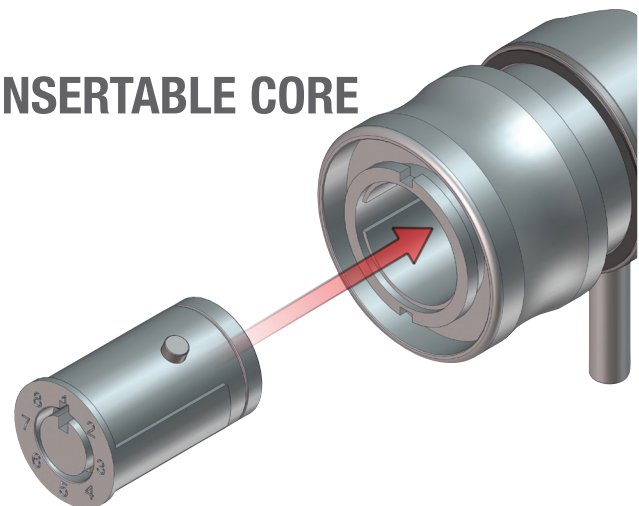

Standard K4 Plating Finishes



* Special K4 Plating Finishes



* Custom K4 Plating Finish

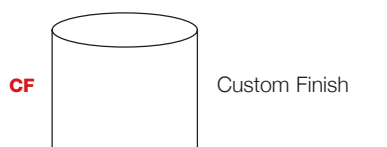

* Extended lead-time and plating lot charges may apply to Special and Custom finishes. Please call Kenstan for details.

K4: K-Series Line of Locks

Our **K4** line of locks are for applications that require a more robust lock or, to replace most I.C. Core lock housings with little to no showcase modification. This line offers all the great features of the K2 such as 8 locks in one, Insertable Core, and the Key Pull feature. Our K2 and K4 locks can be keyed alike making it easy to choose the appropriate size lock for your application. Each key code has eight individual operating keys 1 through 8, used one at a time to operate the lock. Our **Red Change Tool** can reset the lock to allow a new operating key (within the assigned code) to open the lock any time a key is lost or stolen – truly eight locks in one.

The lock can be ordered without the core which can be inserted later, much like our Interchangeable Core and Removable Core Locks. This will allow case builders to install the housings (without the keyed cores) into their cases, stock them and ship them to the stores. Once the cases arrive at the store, loss prevention can install the separately ordered cores and maintain complete Key Control. Of course, if the End-User and/or the Case Builder prefer to receive the complete keyed lock we can ship it as such.

Delivery

At Kenstan, we assemble every lock to order and strive to meet your requested in-house date. Our standard lead-time is to ship within two weeks from the receipt of your order. Rush orders and emergency services are available.

Plating

The **K4** line standard plating finishes are Polished Nickel and Satin Chrome.

A wide range of special plating finishes is also available, including Polished Brass, Matte Black, Statuary Bronze, Satin Brass and Custom Finishes to match your showcase hardware.

Please note: Extended lead-time and plating lot charges may apply to Special and Custom finishes. Please call Kenstan for details.

Key Control

The Keymatic series of locks and keys are built to a high level of precision, making key duplication very difficult. Please note: We recommend our factory original key for smooth lock operation. Use of non-Kenstan copy will void the Kenstan war-ranty on our locks.

We can register your keys and maintain your key plans by store, retail department, showcase/cabinets, or office and we maintain a historical database of key numbers.

The stamped number on the **K4/K2** key will have a prefix letter “P” followed by five numerical digits of which the last one represents the lock setting (1 to 8).

The **Red Change Tool** is stamped with the same code as the operating key, except the setting code is 0.

Key Retaining vs. Non-Key Retaining Lock Function

Key Retaining means that the operating key can be removed in the locked position only. Non-Key Retaining (non-captive) allows the key to be removed in both the locked and unlocked positions, this feature will eliminate the key pull feature on some locks.

Item Number

To determine your item number enter the **RED** option code for each section as in the example below.

A	B	C	D	E	F	G	H	I
CL	K4	05	1203	PN	Y	Y	W	112

A Lock Style

CL Cam Lock

B Core Type*

K4 K⁴ Keymatic Pull

C Housing Length

05 1-3/8"

D Cam Rotation

	LOCKED	OPEN
0312	3	12
0306	3	6
0309	3	9
0612	6	12
0603	6	3
0609	6	9
0912	9	12
0903	9	3
0906	9	6
1203	12	3
1206	12	6
1209	12	9

E Plating Finish

Extended lead-time and plating lot charges
may apply to Special and Custom finishes.

Special Finish	PN	Polished Nickel
	SC	Satin Chrome
	PB	Polished Brass
	SB	Satin Brass
	BL	Matte Black
	ST	Statuary Bronze
	CF	Custom Finish

F Key Retaining

* Note: This option will eliminate the KEYPULL feature.

N* No
Y Yes

G Insert Core

Y Yes
N Pack Core Separately
ND Ship Core to Different Location

H Material Installation

W Wood
M Metal
GR Glass W/ Round Hole
GD Glass W/ DD Hole

Note: Keys are not included with this lock.
See page K410 to order keys.



Lock shown with a Straight Cam.

I Cam Type**STRAIGHT**

102	3/4"
103	7/8"
104	1"
105	1-1/8"
106	1-1/4"
107	1-3/8"
108	1-1/2"
110	1-3/4"
112	2"
116	2-1/2"

HOOK

202	3/4"
204	1"
206	1-1/4"
208	1-1/2"
210	1-3/4"

3/8" OFFSET

511	1-7/8"
------------	--------

CUSTOM CAM

CL

Continued

Data Sheet

C HOUSING LENGTH 05

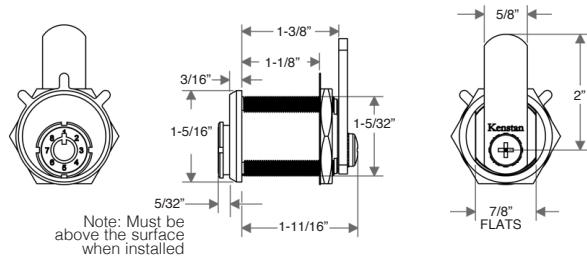

D CAN ROTATION (Front of lock shown)

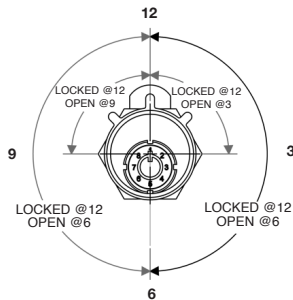

*All 180 degree rotations are clockwise, unless specified.

G WOOD INSTALLATION W

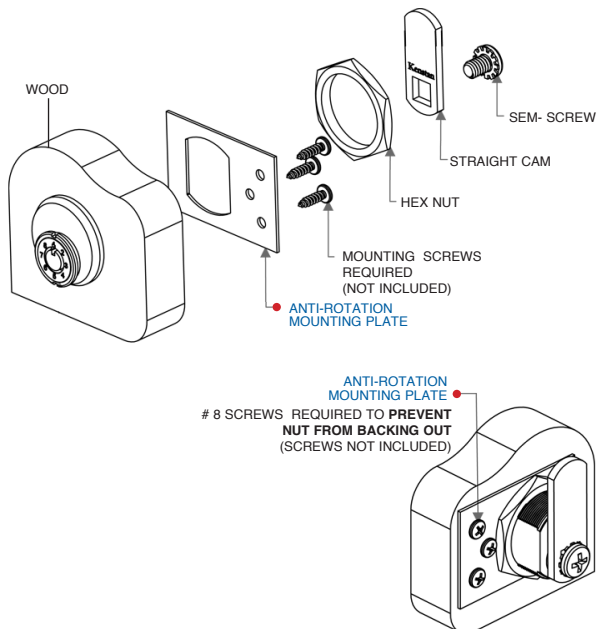

G METAL INSTALLATION M (A double "D" shape hole is required)

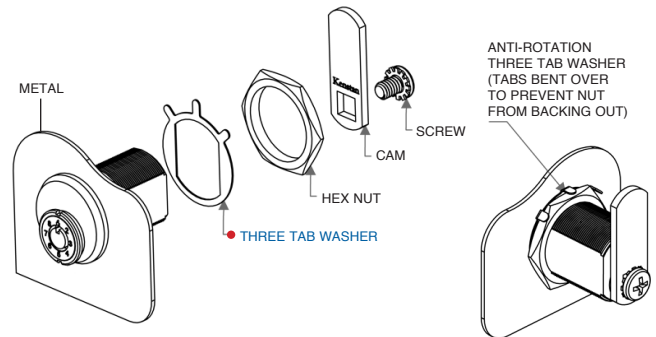

G GLASS INSTALLATION - ROUND HOLE GR

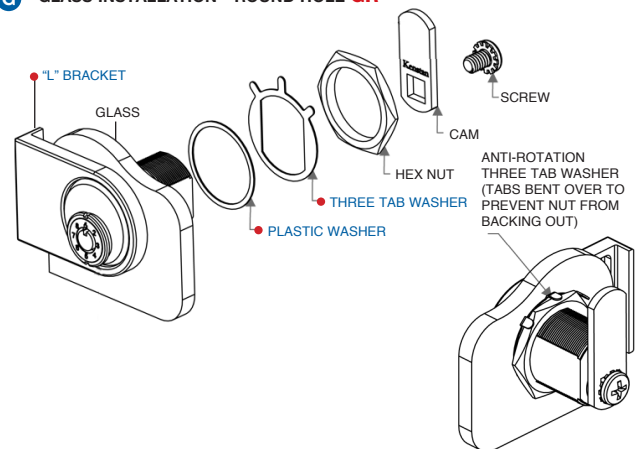

G GLASS INSTALLATION - DOUBLE "D" HOLE GD

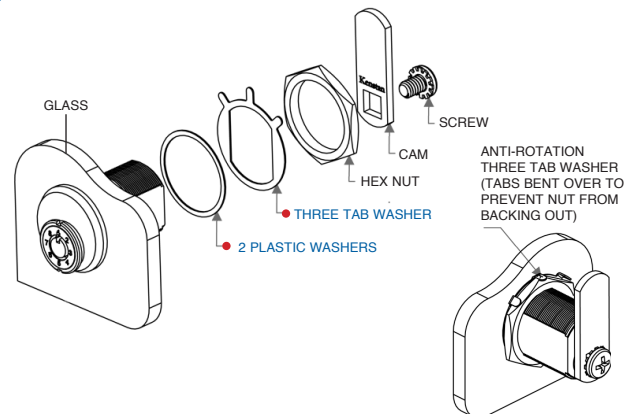

H CAM TYPE

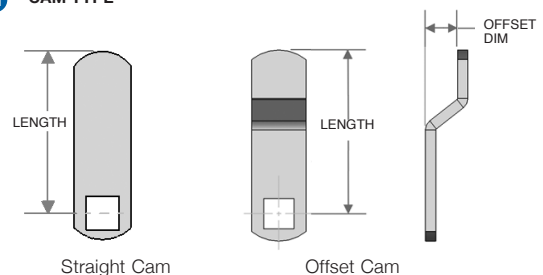

Note: All cams are reversible.

Item Number

To determine your item number enter the **RED** option code for each section as in the example below.

A	B	C	D	E	F	G	H
DL	K4	25	RV	PN	Y	Y	N

A Lock Style

DL Drawer/Door Lock

B Core Type*

K4 K⁴ Keymatic Pull

C Housing Length/Bolt Type

25 Dead Bolt

D Housing Style (Lock can be rotated)**RIM SERIES**

RV Vertical
RI Inverted

E Plating Finish

Extended lead-time and plating lot charges **may** apply to Special and Custom finishes.

Special Finish	PN	Polished Nickel
	SC	Satin Chrome
	PB	Polished Brass
	SB	Satin Brass
	BL	Matte Black
	ST	Statuary Bronze
	CF	Custom Finish

F Key Retaining

* Note: This option will eliminate the KEYPULL feature.

N* No
Y Yes

G Insert Core

Y Yes
N Pack Core Separately
ND Ship Core to Different Location

H Plastic Spacer

N No
Y1 One
Y2 Two
Y3 Three

Note: Keys are not included with this lock.
See page K410 to order keys.



"Throw" (distance bolt travels from the locked to unlocked position) is 3/4".

All dimensions shown are in the locked position.

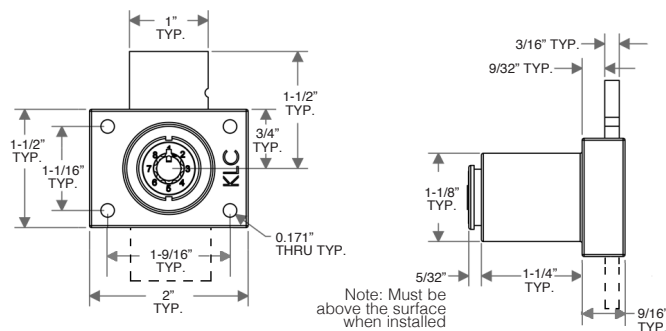
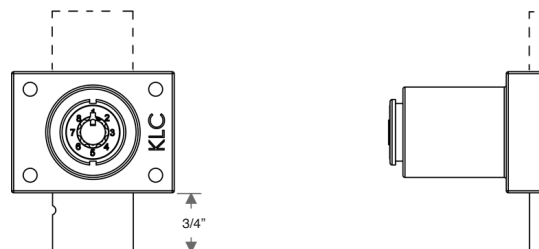
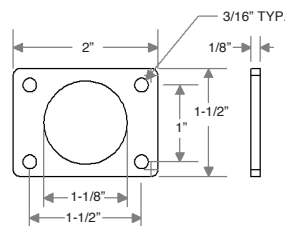
D VERTICAL**D INVERTED****H PLASTIC SPACER**

Data Sheet

Item Number

To determine your item number enter the **RED** option code for each section as in the example below.

A	B	C	D	E	F	G	H
DL	K4	20	RV	PN	Y	Y	N

A Lock Style

DL Drawer/Door Lock

B Core Type*

K4 K⁴ Keymatic Pull

C Housing Length/Bolt Type

20 Straight Dead Bolt
32 Spring
33 Reverse Spring

D Housing Style (Lock can be rotated)

RIM SERIES

RV Vertical

MORTISE SERIES

MV Vertical

E Plating Finish

Extended lead-time and plating lot charges may apply to Special and Custom finishes.

PN Polished Nickel
SC Satin Chrome
PB Polished Brass
SB Satin Brass
BL Matte Black
ST Statuary Bronze
CF Custom Finish

F Key Retaining

* Note: This option will eliminate the KEYPULL feature on dead bolts.

N* No
Y Yes

G Insert Core

Y Yes
N Pack Core Separately
ND Ship Core to Different Location

H Strike Plate

N No
Y Yes

Note: Keys are not included with this lock.

See page K410 to order keys.



"Throw" (distance bolt travels from the locked to unlocked position) is 1/2".

All dimensions shown are in the locked position.

D RIM MOUNT VERTICAL DEAD BOLT

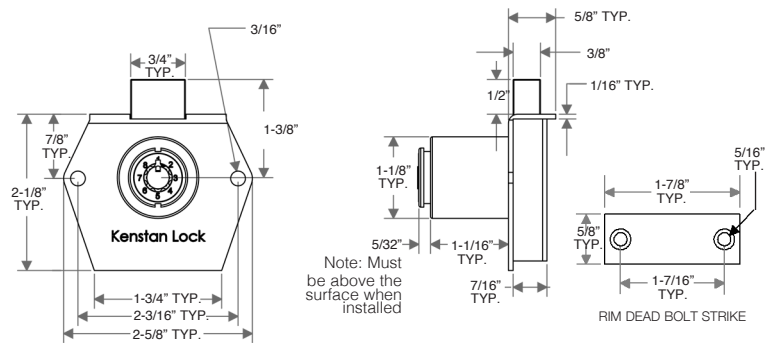

D RIM MOUNT INVERTED SPRING BOLT

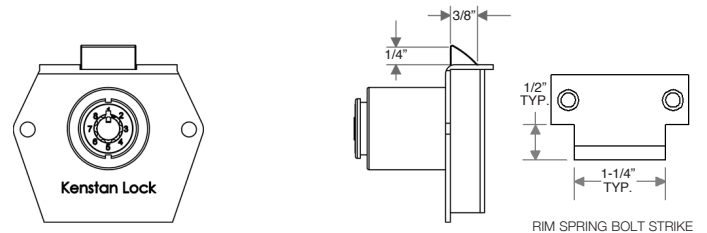

D MORTISE MOUNT VERTICAL DEAD BOLT

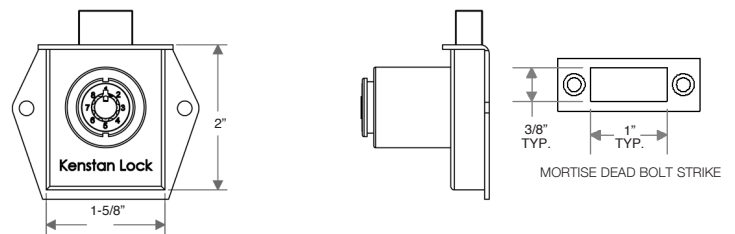

D MORTISE MOUNT VERTICAL SPRING BOLT

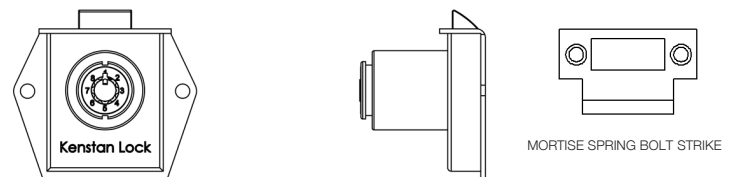

Item Number

To determine your item number enter the **RED** option code for each section as in the example below.

A	B	C	D	E	F	G
GL	K4	R	2424	PN	Y	Y

A Lock Style

GL Gang Lock

B Core Type*

K4 K⁴ Keymatic Pull

C Housing Style

R Rim Series
M Mortise Series

D Mount Style/Bar Length

Notch for Pin must be on Bottom of Drawer	FRONT MOUNT LOCKED UP	
	2424	24"
	2436	36"
	2448	48"
	24CL	Custom
Notch for Pin must be on Top of Drawer	FRONT MOUNT LOCKED DOWN	
	2824	24"
	2836	36"
	2848	48"
	28CL	Custom
Notch for Pin must be on Bottom of Drawer	SIDE MOUNT LOCKED UP	
	2624	24"
	2636	36"
	2648	48"
	26CL	Custom
Notch for Pin must be on Top of Drawer	SIDE MOUNT LOCKED DOWN	
	3024	24"
	3036	36"
	3048	48"
	30CL	Custom

E Plating Finish

Extended lead-time and plating lot charges may apply to Special and Custom finishes.

Special Finish	PN	Polished Nickel
	SC	Satin Chrome
	PB	Polished Brass
	SB	Satin Brass
	BL	Matte Black
	ST	Statuary Bronze
Special Finish	CF	Custom Finish

F Key Retaining

* Note: This option will eliminate the KEYPULL feature.

N* No
Y Yes

G Insert Core

Y Yes
N Pack Core Separately
ND Ship Core to Different Location

Note: Keys are not included with this lock. See page K410 to order keys.

"Throw" (distance bolt travels from the locked to unlocked position) is 1/2".

FRONT MOUNT - FRONT VIEW

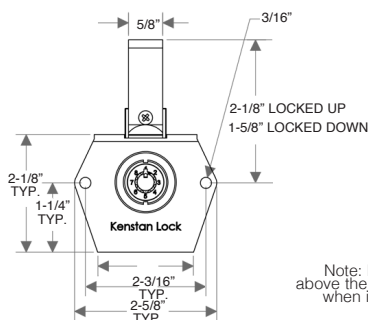

FRONT MOUNT - SIDE VIEW

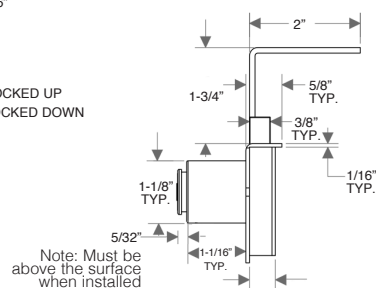

FRONT MOUNT (Shown with a Gang 3C Kit)

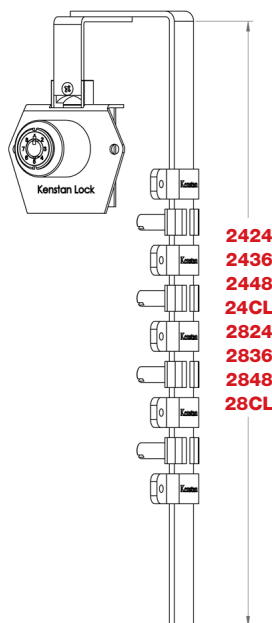

SIDE MOUNT (Shown with a Gang 3C Kit)

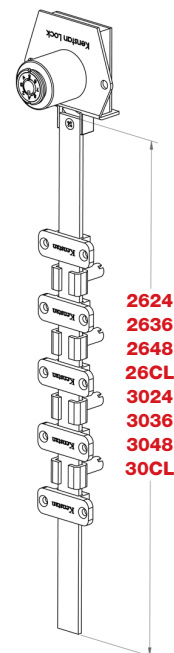

Gang Lock Packages

To determine your item number enter the **RED** option code for each section as in the example below.

A	B	C
GANG	3	C

GANG 3C A kit with three adjustable stops, three 1-1/8" pins, three lock washers, and four closed bar guides.

A Package

GANG

B Number of Drawers

2
3
4

C Pin Length

A 5/8"
B 3/4"
C 1-1/8"
D 1-7/8"

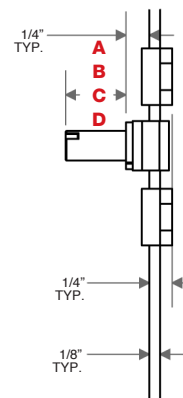

Data Sheet

Item Number

To determine your item number enter the **RED** option code for each section as in the example below.

A	B	C	D	E	F	G	H
PL	K4	40	S6	PN	N	Y	YS

A Lock Style

PL Plunger Lock

B Core Type*

K4 K⁴ Keymatic Pull

C Housing Style

40 Oval Flange

D Plunger Type/Length

LARGE PROFILE S TYPE
S6 1-11/16"

E Plating Finish

Extended lead-time and plating lot charges **may** apply to Special and Custom finishes.

Special Finish	PN	Polished Nickel
	SC	Satin Chrome
	PB	Polished Brass
	SB	Satin Brass
	BL	Matte Black
	ST	Statuary Bronze
	CF	Custom Finish

F Key Retaining

N No

Insert Core

Y	Yes
N	Pack Core Separately
ND	Ship Core to Different Location

H Through Bolt Mount Kit

N No
YS Support Plate

Note: Keys are not included with this lock.
See page K410 to order keys.



Note: This plunger will retract 100% in the open position.

D LARGE PROFILE S PLUNGER

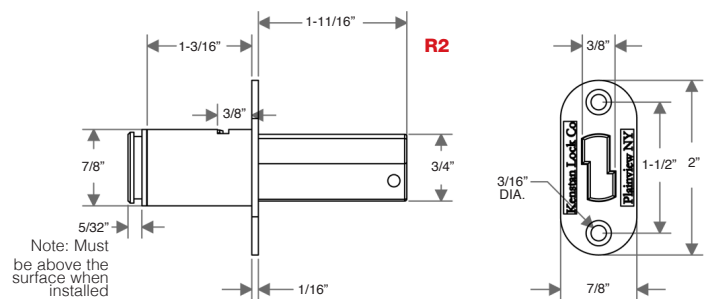

Note: 1/2" minimum material thickness if used without the support plate.

EXPLODED VIEW WITH YS MOUNTING KIT

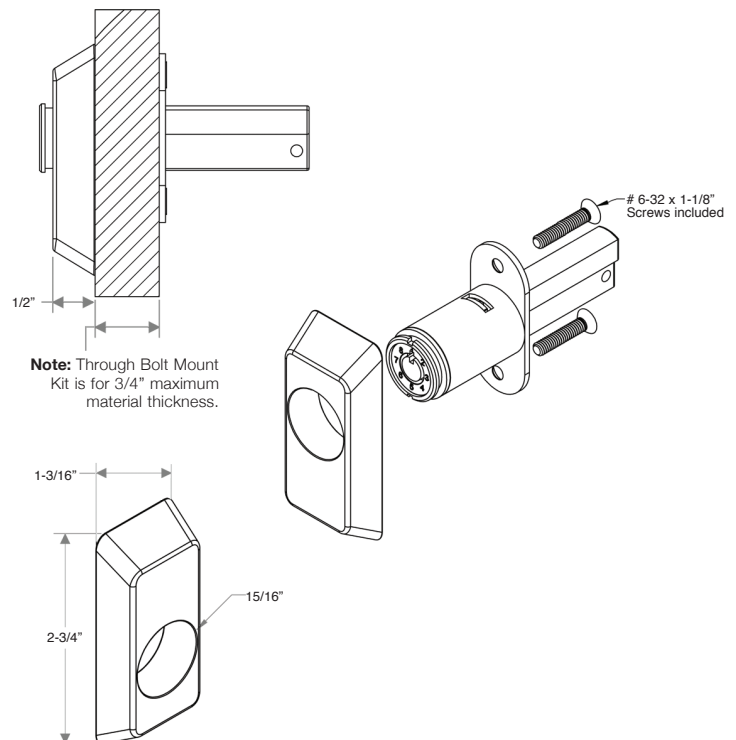

Item Number

To determine your item number enter the **RED** option code for each section as in the example below.

A	B	C	D	E	F	G	H
PL	K4	50	S6A	PN	N	Y	G

A Lock Style

PL Plunger Lock

B Core Type*

K4 K⁴ Keymatic Pull

C Housing Style

50 Round

D Plunger Length/Material Thickness

	PLUNGER	MATERIAL
S6A	1-3/4"	1/4"
S6B	1-5/8"	3/8"
S6C	1-1/4"	3/4"

E Plating Finish

Extended lead-time and plating lot charges may apply to Special and Custom finishes.

Special Finish	PN	Polished Nickel
	SC	Satin Chrome
	PB	Polished Brass
	SB	Satin Brass
	BL	Matte Black
	ST	Statuary Bronze
	CF	Custom Finish

F Key Retaining

N No

G Insert Core

Y	Yes
N	Pack Core Separately
ND	Ship Core to Different Location

H Material

G	Glass
M	Metal
W	Wood

Note: Keys are not included with this lock.
See page K410 to order keys.

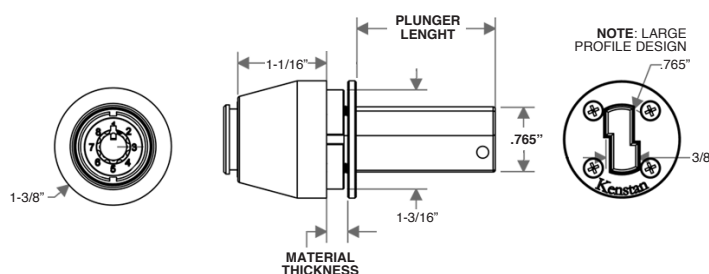
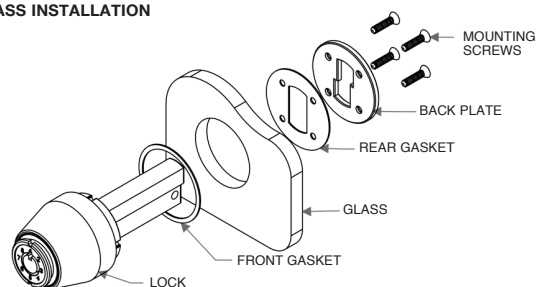
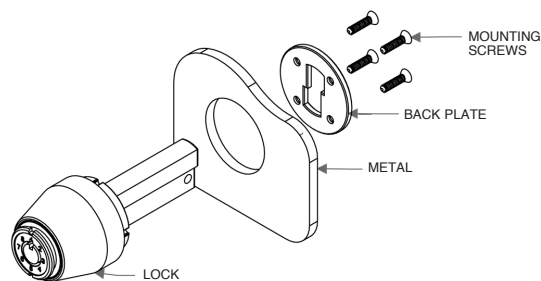
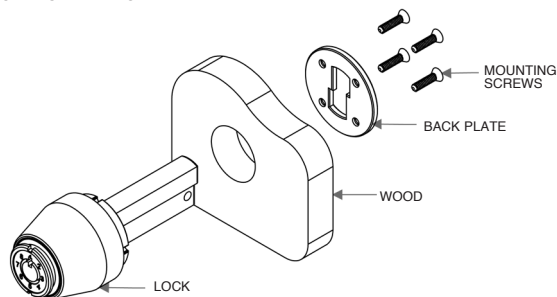

Note: This plunger will retract 100% in the open position.

D PLUNGER LENGTH/MATERIAL THICKNESS**H GLASS INSTALLATION****H METAL INSTALLATION****H WOOD INSTALLATION**

Data Sheet

Item Number

To determine your item number enter the **RED** option code for each section as in the example below.

A	B	C	D	E	F	G
RL	K4	60	B9	PN	N	Y

A Lock Style

RL Ratchet Lock

B Core Type

K4 K⁴ Keymatic Pull

C Housing Style

60 Ratchet

D Bar Type

B1 Standard
B2 Adjustable
B5 Stick on Outer Surface
Best Seller B9 Stick on Inner Surface

E Plating Finish

Extended lead-time and plating lot charges may apply to Special and Custom finishes.

PN Polished Nickel
SC Satin chrome
CF Custom Finish

F Key Retaining

N No
Y Yes (Dead Bolt Design)

G Insert Core

Y Yes
N Pack Core Separately
ND Ship Core to Different Location

Note: Keys are not included with this lock.
 See page K410 to order keys.

D STANDARD BAR **B1**

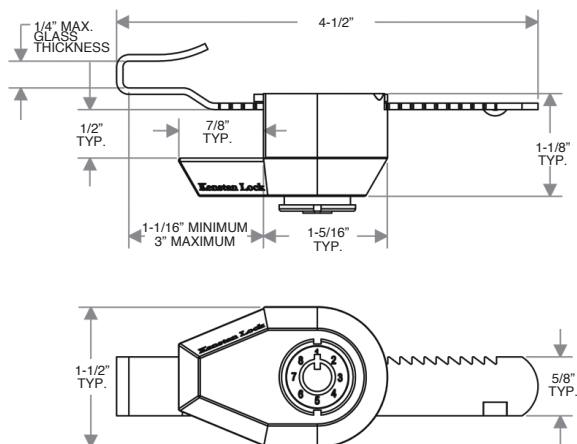

D ADJUSTABLE BAR **B2**

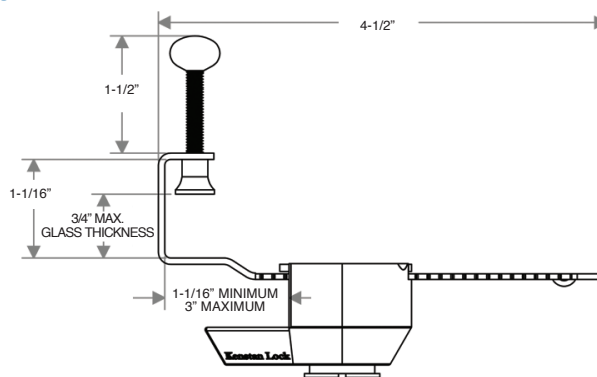

D STICK ON BAR (Outer Surface) **B5**

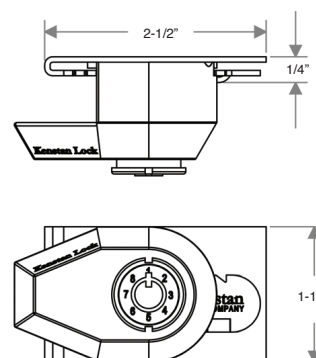

D STICK ON BAR (Inner Surface) **B9**

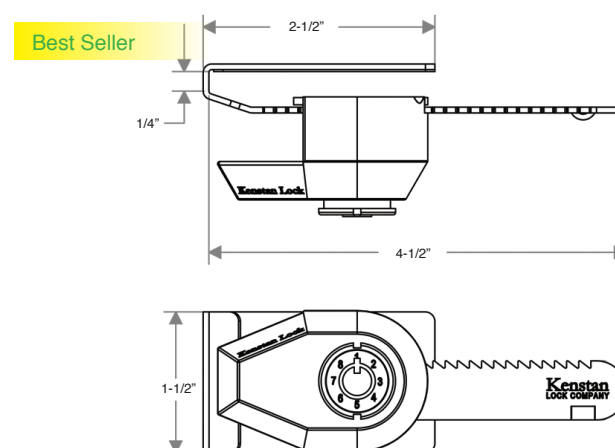

K-Series "K2/K4" Tubular Keys

In the retail industry, opening a showcase has always been a matter of putting the key in the lock and pulling the door or drawer open with the key. Keys and locks were never designed to be used this way. That is until now! We designed our product to accommodate how people actually use their keys. With our K-Series line of locks you still have the same great features of eight locks for the price of one. However, this specially tooled key inter-locks with the face of the lock. Now you can use the key without the risk of damaging the keys or the lock.

Customers now have the option to color code the keys by department or lock setting (1 to 8).

The **Red Change Tool** is stamped with the same code as the operating key, except the setting code is 0.

Item Number

To determine your item number enter the **RED** option code for each section as in the example below.

A	B	C	D	E
KEY	K2	01	BE	XXXXXX

A Item

KEY Key

B Core Type

K2 K² / K⁴ Keymatic

C Operating Key No.

01 One
02 Two
03 Three
04 Four
05 Five
06 Six
07 Seven
08 Eight

D Cover Color

BE Blue
OR Orange
PN Polished Nickel
BL Black
PE Purple
GN Green
YE Yellow
WH White

E Key Code

XXXXXX Specific
 Up to 6 digits
A Any
 Kenstan assigns

OPERATING KEY O-RINGS COLORS

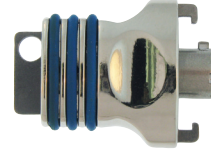

BE
Blue



PE
Purple



OR
Orange



GN
Green



PN
Polished Nickel

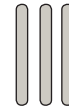

YE
Yellow



BL
Black



WH
White

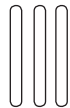

RED CHANGE TOOL TOOL

Item Number

KEY	K2	TOOL	XXXXXX
-----	----	------	--------



1. Pricing: Kenstan Lock reserves the right to institute price adjustments based upon fluctuation of material costs without prior notice. Orders, or balances of orders, that have not shipped within 6 months from the original order date may be subject to a price review.

2. Payment Terms: Payment must be made at time of purchase, unless otherwise approved by Kenstan with terms of Net 30 Days from the date of the invoice. A service charge of 1.5% per month will be charged on overdue accounts.

3. Shipping: Please be sure to specify your preferred shipping method on every order. For all orders received without shipping instructions, Kenstan will use our discretion to make carrier selection based upon the most economical method of shipment available to meet your required in house date. Kenstan is not responsible for risk of loss or damage to products in transit with the selected carrier.

4. Deliveries: At Kenstan, we assemble every lock to order and strive to meet your requested in-house date. Our standard lead time is to ship within two weeks from the receipt of your order. Rush orders and emergency services are available. Unless specifically prohibited in writing by the purchaser, Kenstan reserves the right to make partial shipments of any order.

5. Inspection: Kenstan Lock inspects all products in accordance with our standard quality control procedures. Upon receipt and inspection by the purchaser, any parts proven to be defective or not as ordered may be returned to Kenstan for repair or replacement following the conditions in the "Returned Goods" section (#6) below.

6. Returned Goods: Product replacement or account credit for any returned goods will be made solely at the discretion of Kenstan and will only be accepted upon the issuance of a Return Authorization number from Kenstan's Customer Service Department. Merchandise proven to be defective, due to faulty material and/or workmanship, may be returned for full replacement or credit. Any product ordered incorrectly by the customer may be accepted for return and subject to a 50% handling charge. Locks made with special or out-of production parts are not returnable, unless prior arrangements have been made. Returned merchandise that is damaged in transit, due to inadequate return packaging, will not be accepted.

7. Warranty: Kenstan Lock warrants, for a period of one year from delivery, that our products are free from defects in material and workmanship and makes no other warranties, expressed or implied, including but not limited to the degree of security or the purchaser's application or use of our product. Kenstan Lock Co. will not warranty any locks or parts that were modified outside of our factory. In the event of a product defect, Kenstan shall only be responsible to the extent of the cost of our product, and will not accept any claims for labor or loss of merchandise.

8. Cancellation: If all or any part of an order is cancelled before the completion of the product assembly by Kenstan, the purchaser shall be responsible for payment of all assembled items as well as any special parts ordered for items remaining unassembled at the time of cancellation. If pricing on the original order was based upon Kenstan's quantity discount, a partial cancellation may affect the pricing on items already shipped and invoiced and a price adjustment will be made.

9. Catalog Dimensions and Sample Policy: Please be aware that all lock and part drawing dimensions carry a tolerance of plus or minus 1/16" and are for reference only. Please contact us for actual dimensions. All specifications are subject to change without notice. Samples products are available upon request.